

## Functional Features

4K visible light

3-Axis stabilized gimbal, 120g

Supports 7x digital zoom

Network, S.BUS and UART controls

AI Target Detection and Tracking

TF card double record

## Whole machine structure

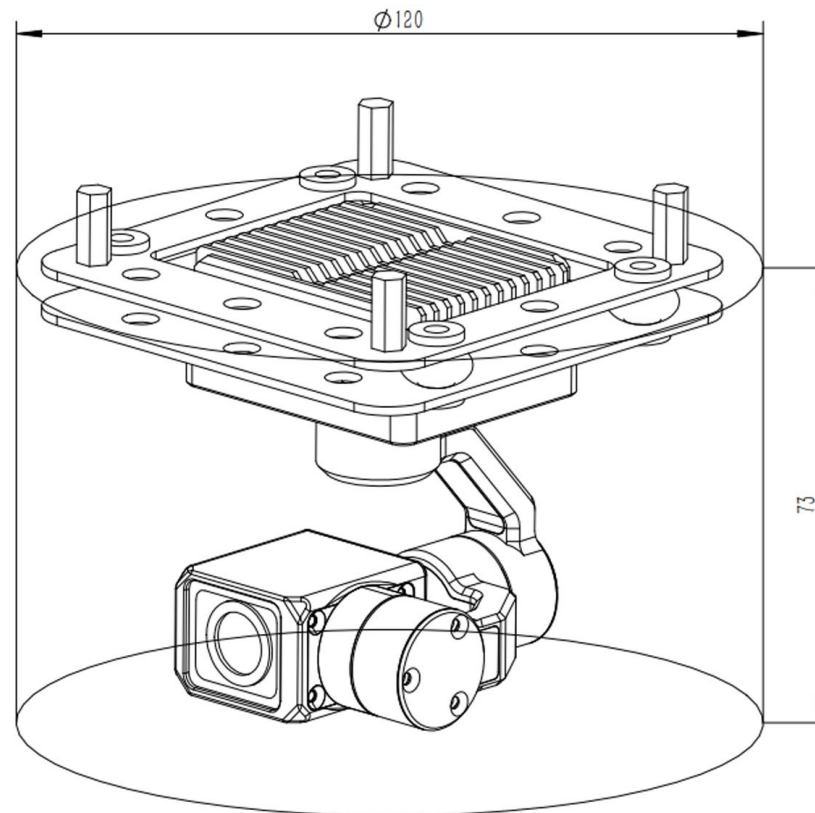

<b>voltage</b>		DC 12V-26.2V <sup>②</sup>
<b>Power</b>		Dynamic 4W
Working Status	<b>Roll Angle action range</b>	-45° ~ +45°
	<b>Pitch Angle action range</b>	-35° ~ +110°
	<b>Heading Angle action range</b>	-140° ~ +140°
	<b>Angle jitter in pitch and roll direction</b>	±0.02°
	<b>Horizontal Angle jitter</b>	±0.03°
	<b>One-click back to center function</b>	One key automatic fast return to the initial position
	<b>Pan- tilt control speed is adjustable</b>	When the pan-tilt rotates, the speed is adaptive based on the current speed mode and the multiple of the visible light camera.
	<b>Control mode</b>	Support network IP control, SBUS control, serial port control (optional PWM control)
Visible light Camera	<b>Sensor</b>	1/2.8 inch 8 megapixel HD CMOS SENSOR
	<b>Digital zoom</b>	Supports 7x digital zoom
	<b>Compressed storage mode</b>	H264, H265, local TF storage for video streams
	<b>HDMI video</b>	Micro-D HDMI 1080P 60fps
	<b>Network Output mode</b>	1080P 30fps
	<b>Angle of view (FOV)</b>	6mm lens, FOV: 60°×43°
DTarget recognition and tracking	<b>Min tracking target size</b>	16×16 pixels
	<b>Max tracking target size</b>	256×256 pixels
	<b>Target Memory Time</b>	2 seconds
	<b>Tracking speed</b>	50 Pixel/Frame max
	<b>Simultaneous detection qty</b>	100 targets max
	<b>Recognized categories</b>	Human and Vehicle
	<b>Min detection target size</b>	32×32 pixels
<b>Dimensions</b>		φ:120mm H: 73mm
<b>Working environment</b>		-10℃ to +45℃/ 20% to 80% RH
<b>Storage environment</b>		-20℃ to +60℃/ 20% to 95% RH
<b>Main applications</b>		Drone aerial photography
<b>Weights</b>		120± 10g

## Structure Installation size

The installation hole spacing of the shock absorber plate is 65.5mm×65.5mm; Installation hole size: M2.5

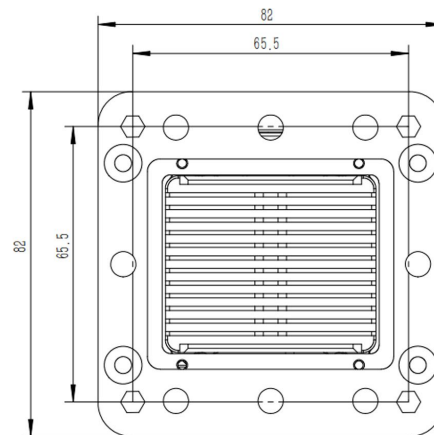

## Connection application diagram

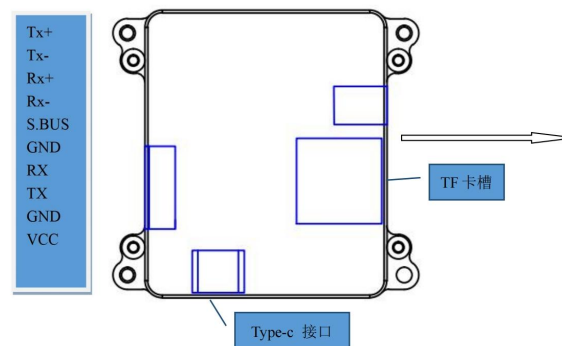

Serial number	Model number	Interface type	Interface definition	Functionality
1	10PIN socket	Communication port	Tx+	Network interface
2		Communication interface	Tx-	Network interface
3		Communication interface	Rx+	Network interface
4		Communication interface	Rx-	Network interface
5		Communication interface	S.BUS	S.BUS input
6		Signal Ground	GND	GND
7		Communication interface	RX	Serial receiver
8		Communication interface	TX	Serial send
9		Power ground	GND	GND
10		Power port	VCC	DC 12V-26.2V

**\* Due to product upgrade, appearance/size/weight/power consumption may change slightly, please contact sales for recent Data. Thanks for understand.**

---

**CONTACT CHINA MONEYPRO GROUP NOW:**

**EMAIL: SALES@MONEYPROUAV.COM**

**MOBILE: +86-18126437260 (WHAT'S UP) MS. AMY LUO**