

Features

- 30X Continuous Optical Zoom
- 50m~8000m Laser Rangefinder
- Medium Wave Refrigeration 640×512 IR
- AI object recognition: human, vehicle, ship, and target recognition.
- AI assisted locking: automatic target recognition and tracking.
- AI Anti occlusion Tracking: Object Recognition Assisted Stable Tracking.
- Two-axis stability: comprehensive isolation of carrier angular motion.
- Three-sensor photography and recording: supports post analysis.
- Electronic image stabilization: sub-pixel level stable experience.

- Anti link delay: moving objects, precise locking.
- Multiple objects recognition and tracking: supports keyboard locking of objects and voice locking of objects.
- Web page remote upgrade: remote support, second level response.

Structure

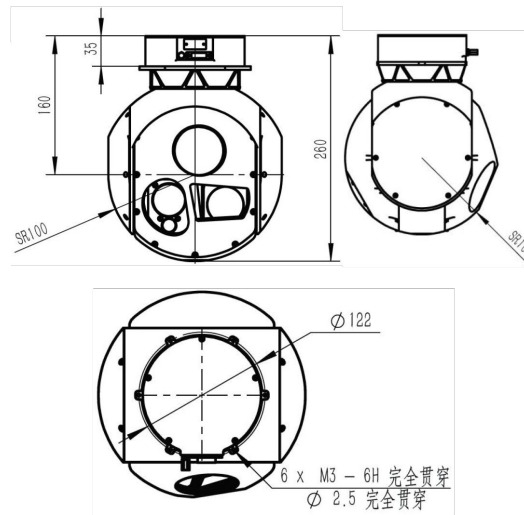

➤ Recognition Effect



EO	
Band	0.4μm~0.9μm
Resolution Ratio	1920×1080
Focal Length	F=4.3~129mm
Viewing Angle	63.7°~ 2.3°
Optical Zoom	30X
Detection Range	Human 6km, ,vehicle 15km
Recognition Distance	Human 2km, ,vehide 8km
Single Object tracking	
Object Type	generic objectives
Tracking Rate	≥32 pixel/frame
Update Frame rate	≥50FPS
Multiple Objects tracking	
Object Type	human, vehicle, ships, airplanes
Recall	≥90%
Accuracy	≥80%
Minimum Target Size	32×32 @1080P
Tracking Target Quantity	≥20
Tracking Transition Rate	≤15%
Update Frame rate	≥20FPS
Video and Storage	
Photo Format	JPEG
Video Format	MP4
Encoding Format	H.264、H.265 etc
Video Protocol	TS、RTSP、RTMP、UDP etc
Storage	128GB
Environment Temperature	
Operation Temperature	-40℃~ 60℃
Storage Temperature	-45℃~70℃
Impact	20g,11ms

IR	
Band	3μm~5μm
Cooling time	≤6min
Resolution Ratio	640×512
Pixel	15μm
Focal Length	40~220mm zoom//F4.0
Viewing Angle	13.69°~2.5°
Detection Range	Human 6.8km,Vehicle 29.2km
Recognition Distance	Human 1.7km. Vehicle 7.3km
Laser Rangefinder	
Band	1535nm
Ranging Range	50m~8000m
Range Accuracy	±1m
Range Frequency	1~10Hz
Servo	
Heading range	N×360°
Pitch range	-120°~ 40°
Consistency in accuracy	<100urad (2°/1Hz,1°/2Hzz frequency fluctuation)
Angular Measurement Accuracy	≤1mrad
Angular Velocity	≥60°/s
Angular Acceleration	≥150°/s²
Interface Size	
Dimension	≤Φ200mm×260mm
Weight	≤5kg
Power Supply	18~28VDC,(featuring spike and surge protection capabilities)
Consumption	50w (average) 100w (peak value)
Communication Interface	Serial port ,1Gbps
Video Interface	1Gbps,SDI

Interface Definition

Connector 1

Model: J30J-25ZKP

Connector 1 Definition							
No.	Signal Definition	Signal Description	Remark	No.	Signal Definition	Signal Description	Remark
1	VCC	Positive power supply		14	VCC	Positive power supply	
2	VCC			15	GND	Negative power supply	
3	GND	Negative power supply		16	GND		
4	TTL_TX	Debug serial port		17	RS422_TX+	Communication serial port	
5	TTL_RX			18	RS422_TX-		
6	PPS_IN	Satellite input interface		19	RS422_RX+		
7	RS232_TX			20	RS422_RX-		
8	RS232_RX			21	DGND		
9	DGND			22	GBE_N0	Gigabit Ethernet GBE_N	
10	GBE_P0	Gigabit Ethernet GBE_P		23	GBE_N1		
11	GBE_P1			24	GBE_N2		
12	GBE_P2			25	GBE_N3		
13	GBE_P3						

Connector 2

Model:SSMA-KY-1.5 Impedance: 75Ω

***Due to product upgrades, the appearance/size/weight/power consumption may change slightly. Please contact sales for the latest data. Thank you for your understanding.**

CONTACT CHINA MONEYPRO GROUP NOW:

EMAIL: SALES@MONEYPROUAV.COM

MOBILE: +86-18126437260 (WHAT'S UP) MS. AMY LUO