

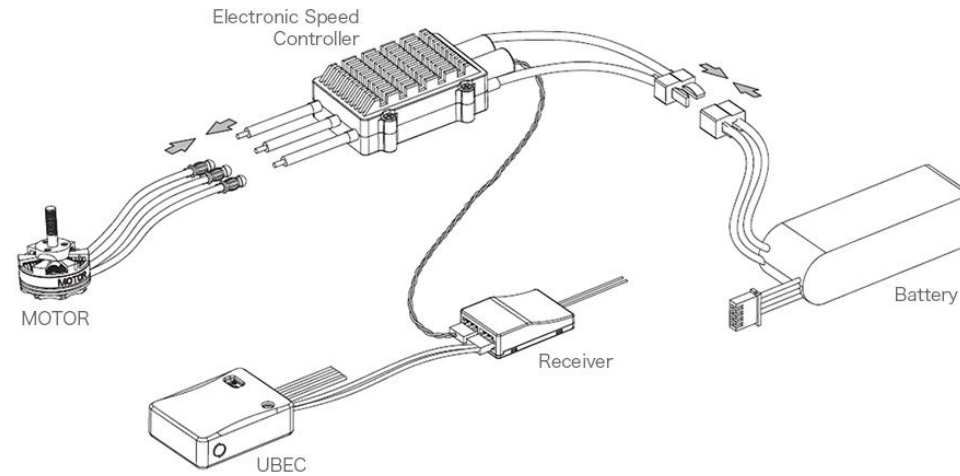

THROTTLE CALIBRATION

*Please calibrate the throttle range when you use a new FLAME ESC or RC.

Step 1: Wiring Diagram



⚠ For safety sake, please remove the propellers during throttle calibration !

Step 2: Throttle Range Calibration

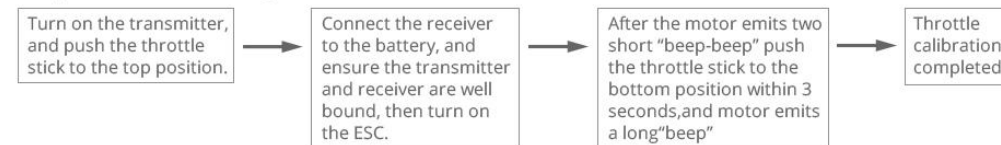

*If the throttle stick is not pushed to the bottom position, motor will emit short beeps. In that case, you need to recalibrate!

Step 3: ESC Programming (For FLAME 80A 12S V2.0 only)

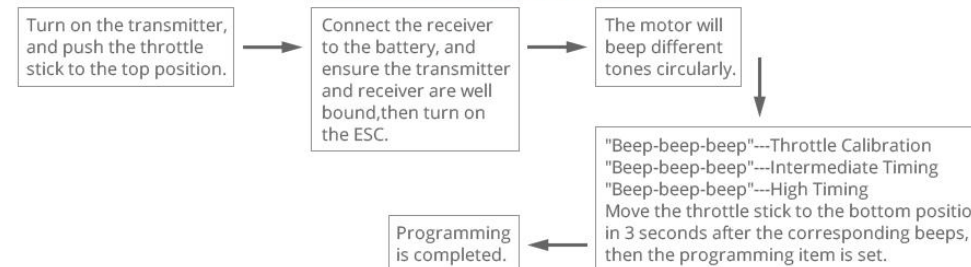

Drawing

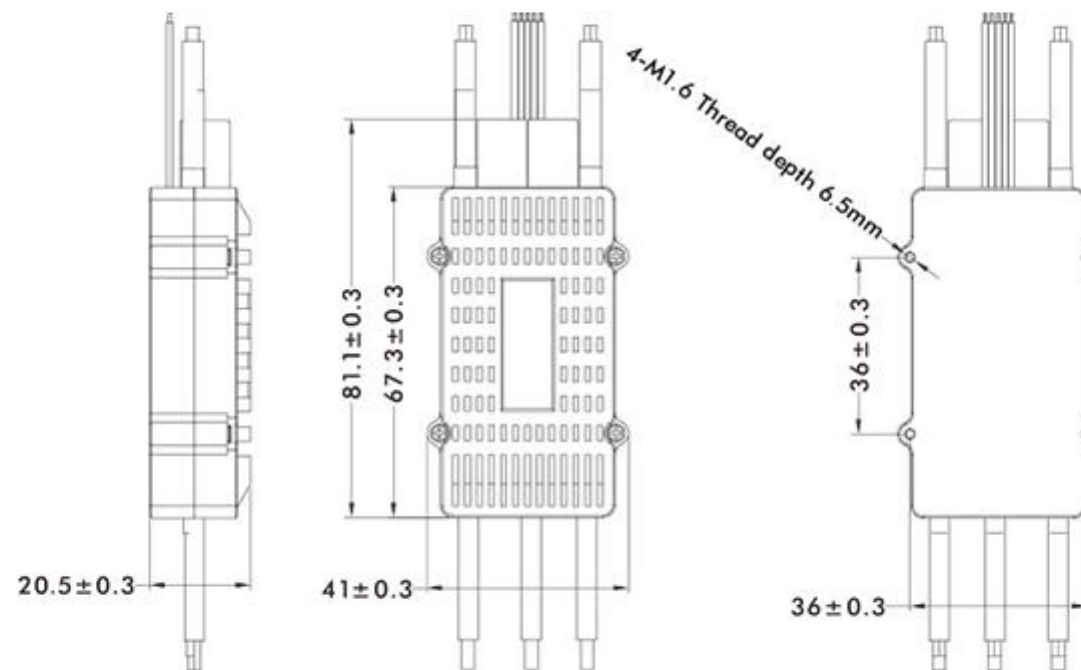



CONTACT CHINA MONEYPRO GROUP NOW:

EMAIL: SALES@MONEYPROUAV.COM

MOBILE: +86-18126437260 (WHAT'S UP) MS. AMY LUO